

## Epoxy Roller Runners

### 15018 EPOXY SLIDE, FERRARI



\* 400 mm pictured

- Material: steel
- Closing: self-close
- Opening: single extension
- Screwing: bottom-mount with screws
- Color: epoxy powder coated
- Packing: set or industrial
- Loading: 15 kg for 0.8 mm material thickness  
25 kg for 1.2 mm material thickness
- POM roller with 18.5 mm or 19 mm

Note: Hole pattern printed represents our prototype and there are more options. It might have been altered according to our customer's needs. Dimensions in mm

#### Installation guide

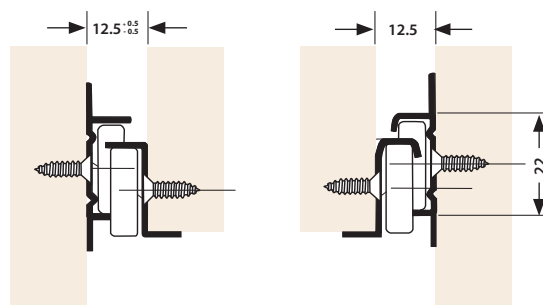

#### Fixing dimension on the cabinet

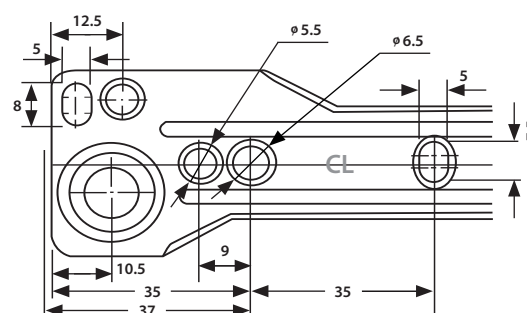

#### Drilling pattern

